



**SEALFAST**  
THE SIMPLE SOLUTION

# COUPLINGS & ACCESSORIES



TYPE E

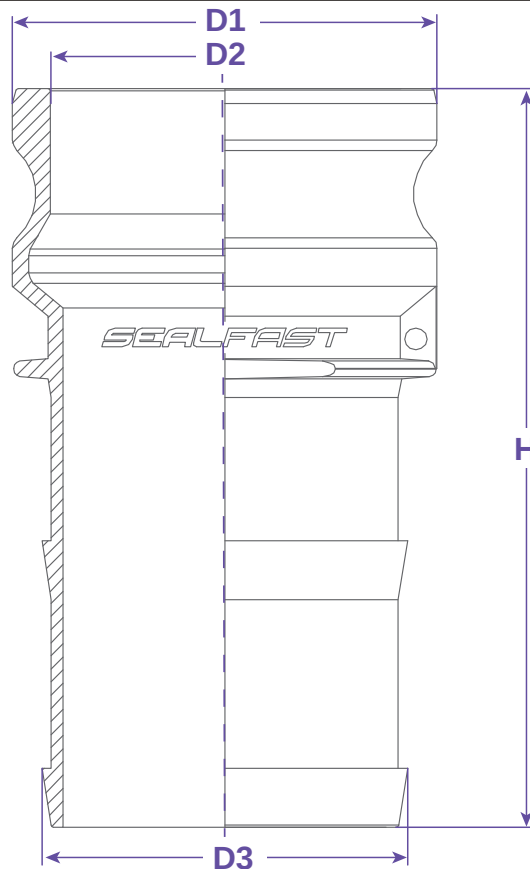

Size	PSI	D1	D2	D3	H	PART #
1/2"	125	0.957	0.634	0.595	2.697	E050SS, SS304
1/2" x 3/4"						E05075SS
3/4"	150	1.264	0.985	0.780	3.347	E075SS, SS304
1"	150	1.445	1.091	1.051	3.839	E100SS, SS304
1-1/4"	150	1.791	1.343	1.303	4.173	E125SS, SS304
1-1/2"	150	2.102	1.591	1.567	4.409	E150SS, SS304
2"	150	2.484	1.949	2.067	5.610	E200SS, SS304
2-1/2"	150	2.984	2.492	2.520	5.551	E250SS, SS304
3"	150	3.602	3.201	3.098	6.260	E300SS, SS304
4"	150	4.705	4.303	4.098	7.146	E400SS, SS304
5"	75	5.728	5.098	5.551	7.795	E500SS, SS304
6"	75	6.929	6.138	6.055	8.051	E600SS, SS304
8"	40	8.921	7.835	8.138	9.095	E800SSPTK

## FEATURES & APPLICATIONS:

### • General Uses:

A camlock fitting is a type of coupling that is used to connecting hose and or pipes together that transfers liquids, powders and granules. A straight through connection is made that maintains the pipe size and allows the free flow of materials being transferred.

**WARNING:** Cam & Groove Couplings should **NOT** be used with any compressed gas, including steam or air. Metal fittings should **NOT** be used with Polypropylene Cam & Groove. Dust Caps and Dust Plugs are **NOT** designed for pressure applications.

Note: All Seal Fast Cam & Groove Stainless Bodies are 316 Investment with 304 Handles.

## TITLE TYPE E - MALE ADAPTER X SHANK

### DISCLAIMER

All drawings and specifications are subject to change without notice. Drawings represent general dimensions of our products. Seal Fast cannot guarantee the dimensions in the drawing will exactly match those in the drawing. This drawing is the property of Seal Fast Inc. Copying or reproduction of this drawing is expressly prohibited.

### MATERIAL

SUS 316, 304

DRAWING NOT TO SCALE

### PART #

E...SS, SS304

